

WiFi 7 (802.11BE) 2x2 MU-MIMO 2.4+5GHz Dual Band Dual Concurrent Wireless Module

Model: WLE7002E25



KEY FEATURES

- Qualcomm QCN6274 'Waikiki' series for Commercial Grade
- Qualcomm QCN9274 'Waikiki' series for Industrial Grade
- 2.4GHz, 2x2 MU-MIMO, up to 688 Mbps physical data rate
- 5GHz, 2x2 MU-MIMO, up to 2882 Mbps physical data rate
- Dual-Band Concurrent 2.4+5GHz WiFi 7 (802.11be)
- MiniPCIe Interface with PCIe 3.0
- Based on WK03.2 reference design
- Supports up to 4096-QAM
- -20°C to 70°C operating temperature for commercial grade
- -40°C to 85°C operating temperature for industrial grade

Specifications

Chipset	Qualcomm QCN6274 'Waikiki' series for Commercial grade Qualcomm QCN9274 'Waikiki' series for Industrial grade
System Memory	2Mbit serial I ² C bus EEPROM
Reference Design	WK03.2
Host Interface	MiniPCIe Interface with PCIe 3.0
Operating Voltage	3.3V
Power Consumption	8W(Max)
Wireless	2.4GHz 802.11b/g/n/ax/be, max 22dBm per chain 5GHz 802.11a/n/ax/be, max 21dBm per chain 4x U.FL Connectors
Frequency Range	2.4 GHz: 2.412~2.472GHz 5 GHz: 5.150~5.825GHz
Modulation Techniques	OFDMA: BPSK, QPSK, DBPSK, DQPSK, 16-QAM, 64-QAM, 256-QAM, 1024QAM, 4096QAM
Channel Spectrum Widths for WLAN	Supports 20/40MHz at 2.4GHz Supports 20/40/80/160MHz at 5GHz
Operating Systems	OpenWRT
Certification	REACH & RoHS Compliance
Environmental Temperature	Operating(Commercial Grade): -20°C to 70°C, Storage: -40°C to 90°C Operating(Industrial Grade): -40°C to 85°C, Storage: -40°C to 90°C
Environmental Humidity, Non-Condensing	Operating: 5% to 95%, Storage: Max. 90%
Dimensions (W x H x D) in mm	30 X 50.8 X 13 mm

*Configurations are subject to change without notifications.

**Can be requested from respective sales executive.

Copyright © Compex Systems. All rights reserved. COMPEX and the COMPEX logo, are registered trademarks of Compex Systems Pte Ltd. While every effort is made to ensure the information is accurate, Compex does not accept liability for any errors or mistakes that may arise. All specifications are subject to change without notice.

RF Performance Table at 2.4GHz

	Data Rate	TX Power (per chain)	TX Power (2 chains)	Tolerance
2.4GHz 802.11be EHT20	MCS 0	20dBm	23dBm	±2dB
	MCS 1	20dBm	23dBm	±2dB
	MCS 2	20dBm	23dBm	±2dB
	MCS 3	20dBm	23dBm	±2dB
	MCS 4	19dBm	22dBm	±2dB
	MCS 5	18dBm	21dBm	±2dB
	MCS 6	17dBm	20dBm	±2dB
	MCS 7	16dBm	19dBm	±2dB
	MCS 8	15dBm	18dBm	±2dB
	MCS 9	15dBm	18dBm	±2dB
	MCS 10	14dBm	17dBm	±2dB
	MCS 11	14dBm	17dBm	±2dB
	MCS 12	13dBm	16dBm	±2dB
	MCS 13	12dBm	15dBm	±2dB
2.4GHz 802.11be EHT40	MCS 0	20dBm	23dBm	±2dB
	MCS 1	20dBm	23dBm	±2dB
	MCS 2	20dBm	23dBm	±2dB
	MCS 3	20dBm	23dBm	±2dB
	MCS 4	19dBm	22dBm	±2dB
	MCS 5	18dBm	21dBm	±2dB
	MCS 6	17dBm	20dBm	±2dB
	MCS 7	16dBm	19dBm	±2dB
	MCS 8	15dBm	18dBm	±2dB
	MCS 9	15dBm	18dBm	±2dB
	MCS 10	14dBm	17dBm	±2dB
	MCS 11	14dBm	17dBm	±2dB
	MCS 12	13dBm	16dBm	±2dB
	MCS 13	12dBm	15dBm	±2dB

	Data Rate	RX Specifications Sensitivity	Tolerance
2.4GHz 802.11be EHT20	MCS 0	-96dBm	±2dB
	MCS 1	-95dBm	±2dB
	MCS 2	-93dBm	±2dB
	MCS 3	-90dBm	±2dB
	MCS 4	-87dBm	±2dB
	MCS 5	-83dBm	±2dB
	MCS 6	-81dBm	±2dB
	MCS 7	-79dBm	±2dB
	MCS 8	-76dBm	±2dB
	MCS 9	-73dBm	±2dB
	MCS 10	-70dBm	±2dB
	MCS 11	-68dBm	±2dB
	MCS 12	-64dBm	±2dB
	MCS 13	-61dBm	±2dB
2.4GHz 802.11be EHT40	MCS 0	-95dBm	±2dB
	MCS 1	-93dBm	±2dB
	MCS 2	-90dBm	±2dB
	MCS 3	-88dBm	±2dB
	MCS 4	-85dBm	±2dB
	MCS 5	-81dBm	±2dB
	MCS 6	-79dBm	±2dB
	MCS 7	-77dBm	±2dB
	MCS 8	-73dBm	±2dB
	MCS 9	-71dBm	±2dB
	MCS 10	-67dBm	±2dB
	MCS 11	-65dBm	±2dB
	MCS 12	-61dBm	±2dB
	MCS 13	-58dBm	±2dB

RF Performance Table at 5GHz

	Data Rate	TX Power (per chain)	TX Power (2 chains)	Tolerance
5GHz 802.11be EHT20	MCS 0	20dBm	23dBm	±2dB
	MCS 1	20dBm	23dBm	±2dB
	MCS 2	19dBm	22dBm	±2dB
	MCS 3	19dBm	22dBm	±2dB
	MCS 4	19dBm	22dBm	±2dB
	MCS 5	18dBm	21dBm	±2dB
	MCS 6	17dBm	20dBm	±2dB
	MCS 7	17dBm	20dBm	±2dB
	MCS 8	16dBm	19dBm	±2dB
	MCS 9	16dBm	19dBm	±2dB
	MCS 10	15dBm	18dBm	±2dB
	MCS 11	14dBm	17dBm	±2dB
	MCS 12	13dBm	16dBm	±2dB
	MCS 13	13dBm	16dBm	±2dB
5GHz 802.11be EHT40	MCS 0	20dBm	23dBm	±2dB
	MCS 1	20dBm	23dBm	±2dB
	MCS 2	19dBm	22dBm	±2dB
	MCS 3	19dBm	22dBm	±2dB
	MCS 4	19dBm	22dBm	±2dB
	MCS 5	18dBm	21dBm	±2dB
	MCS 6	17dBm	20dBm	±2dB
	MCS 7	17dBm	20dBm	±2dB
	MCS 8	16dBm	19dBm	±2dB
	MCS 9	16dBm	19dBm	±2dB
	MCS 10	15dBm	18dBm	±2dB
	MCS 11	14dBm	17dBm	±2dB
	MCS 12	13dBm	16dBm	±2dB
	MCS 13	13dBm	16dBm	±2dB
5GHz 802.11be EHT80	MCS 0	20dBm	23dBm	±2dB
	MCS 1	20dBm	23dBm	±2dB
	MCS 2	19dBm	22dBm	±2dB
	MCS 3	19dBm	22dBm	±2dB
	MCS 4	19dBm	22dBm	±2dB
	MCS 5	18dBm	21dBm	±2dB
	MCS 6	17dBm	20dBm	±2dB
	MCS 7	17dBm	20dBm	±2dB
	MCS 8	16dBm	19dBm	±2dB
	MCS 9	16dBm	19dBm	±2dB
	MCS 10	15dBm	18dBm	±2dB
	MCS 11	14dBm	17dBm	±2dB
	MCS 12	13dBm	16dBm	±2dB
	MCS 13	12dBm	15dBm	±2dB

	Data Rate	RX Specifications Sensitivity	Tolerance
5GHz 802.11be EHT20	MCS 0	-96dBm	±2dB
	MCS 1	-94dBm	±2dB
	MCS 2	92dBm	±2dB
	MCS 3	-88dBm	±2dB
	MCS 4	-85dBm	±2dB
	MCS 5	-81dBm	±2dB
	MCS 6	-79dBm	±2dB
	MCS 7	-77dBm	±2dB
	MCS 8	-74dBm	±2dB
	MCS 9	-71dBm	±2dB
	MCS 10	-68dBm	±2dB
	MCS 11	-65dBm	±2dB
	MCS 12	-61dBm	±2dB
	MCS 13	-58dBm	±2dB
5GHz 802.11be EHT40	MCS 0	-94dBm	±2dB
	MCS 1	-91dBm	±2dB
	MCS 2	-89dBm	±2dB
	MCS 3	-84dBm	±2dB
	MCS 4	-82dBm	±2dB
	MCS 5	-78dBm	±2dB
	MCS 6	-76dBm	±2dB
	MCS 7	-75dBm	±2dB
	MCS 8	-71dBm	±2dB
	MCS 9	-68dBm	±2dB
	MCS 10	-65dBm	±2dB
	MCS 11	-62dBm	±2dB
	MCS 12	-59dBm	±2dB
	MCS 13	-56dBm	±2dB
5GHz 802.11be EHT80	MCS 0	-90dBm	±2dB
	MCS 1	-88dBm	±2dB
	MCS 2	-85dBm	±2dB
	MCS 3	-82dBm	±2dB
	MCS 4	-79dBm	±2dB
	MCS 5	-75dBm	±2dB
	MCS 6	-73dBm	±2dB
	MCS 7	-72dBm	±2dB
	MCS 8	-68dBm	±2dB
	MCS 9	-65dBm	±2dB
	MCS 10	-61dBm	±2dB
	MCS 11	-59dBm	±2dB
	MCS 12	-56dBm	±2dB
	MCS 13	-52dBm	±2dB

RF Performance Table at 5GHz

	Data Rate	TX Power (per chain)	TX Power (2 chains)	Tolerance
5GHz 802.11be EHT160	MCS 0	20dBm	23dBm	±2dB
	MCS 1	20dBm	23dBm	±2dB
	MCS 2	19dBm	22dBm	±2dB
	MCS 3	19dBm	22dBm	±2dB
	MCS 4	19dBm	22dBm	±2dB
	MCS 5	18dBm	21dBm	±2dB
	MCS 6	17dBm	20dBm	±2dB
	MCS 7	16dBm	19dBm	±2dB
	MCS 8	16dBm	19dBm	±2dB
	MCS 9	15dBm	18dBm	±2dB
	MCS 10	15dBm	18dBm	±2dB
	MCS 11	14dBm	17dBm	±2dB
	MCS 12	13dBm	16dBm	±2dB
	MCS 13	12dBm	15dBm	±2dB

	Data Rate	RX Specifications Sensitivity	Tolerance
5GHz 802.11be EHT160	MCS 0	-88dBm	±2dB
	MCS 1	-85dBm	±2dB
	MCS 2	-83dBm	±2dB
	MCS 3	-80dBm	±2dB
	MCS 4	-77dBm	±2dB
	MCS 5	-72dBm	±2dB
	MCS 6	-70dBm	±2dB
	MCS 7	-68dBm	±2dB
	MCS 8	-64dBm	±2dB
	MCS 9	-62dBm	±2dB
	MCS 10	-58dBm	±2dB
	MCS 11	-56dBm	±2dB
	MCS 12	-53dBm	±2dB
	MCS 13	-50dBm	±2dB

Component Map



Mechanical Dimensions

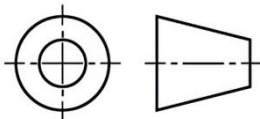
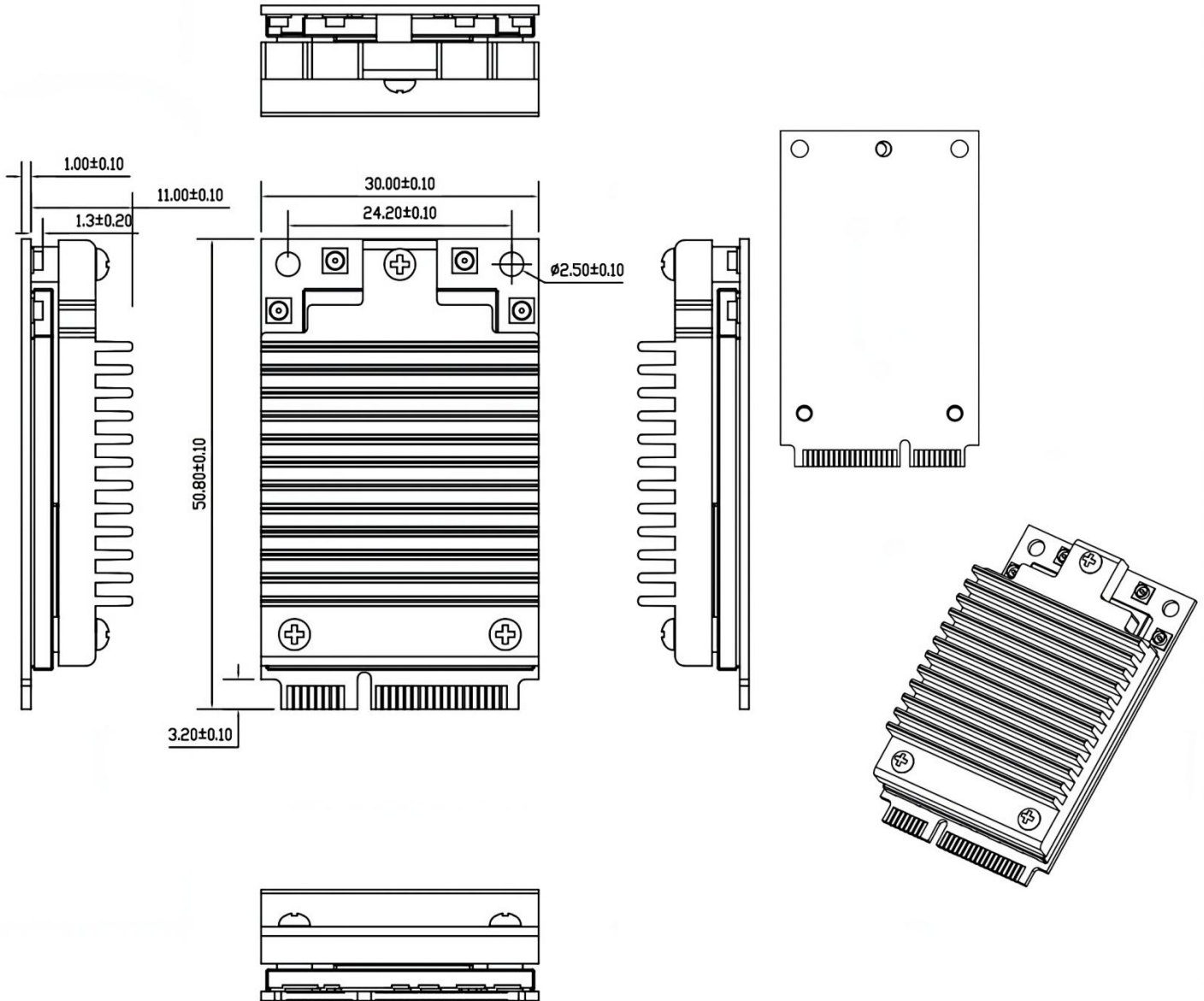

All dimensions are in mm

Ordering Configuration

Item Code	Model	Description
WLE7002E25 7A0674S-TE	WLE7002E25 SKY FEM	QCN6274 2x2 802.11a/b/g/n/ac/ax/be support 2.4+5GHz Dual-Band Concurrent MiniPCIe interface with PCIe 3.0 Module
WLE7002E25 7B0974S-I-TE	WLE7002E25-I SKY FEM	QCN9274 2x2 802.11a/b/g/n/ac/ax/be support 2.4+5GHz Dual-Band Concurrent MiniPCIe interface with PCIe 3.0 Module
WLE7002E25 7A0674K-TE	WLE7002E25 KCT FEM	QCN6274 2x2 802.11a/b/g/n/ac/ax/be support 2.4+5GHz Dual-Band Concurrent MiniPCIe interface with PCIe 3.0 Module
WLE7002E25 7B0974K-I-TE	WLE7002E25-I KCT FEM	QCN9274 2x2 802.11a/b/g/n/ac/ax/be support 2.4+5GHz Dual-Band Concurrent MiniPCIe interface with PCIe 3.0 Module