

WiFi 7 (802.11be) 4x4 MU-MIMO 5GHz Single Band Wireless Module

Model: WLW7000E5

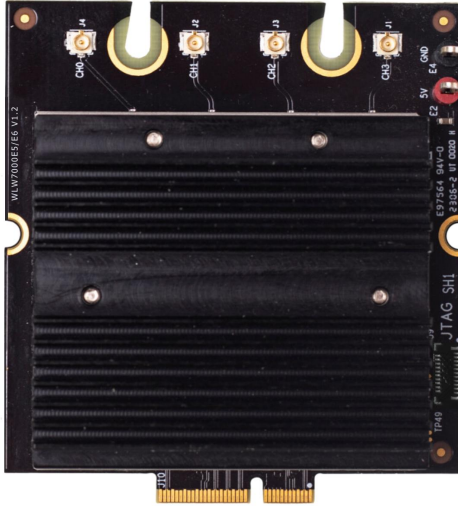

KEY FEATURES

- Qualcomm QCN6224/6274 'Waikiki' series for Commercial Grade
- Qualcomm QCN9274 'Waikiki' series for Industrial Grade
- 5GHz, 4x4 MU-MIMO, up to 8647 Mbps physical data rate
- M.2 E Key interface with PCIe 3.0
- Based on WK01.5 reference design
- Supports up to 4096-QAM
- -20°C to 70°C operating temperature for commercial grade
- -40°C to 85°C operating temperature for industrial grade

Specifications

| | |
|--|--|
| Chipset | Qualcomm QCN6224/6274 'Waikiki' series for Commercial Grade Qualcomm QCN9274 'Waikiki' series for Industrial Grade |
| System Memory | 2Mbit serial I ² C bus EEPROM |
| Reference Design | WK01.5 |
| Host Interface | M.2 E Key interface with PCIe 3.0 |
| Operating Voltage | 5V |
| Power Consumption | 13W (Max) |
| Wireless | 5GHz 802.11a/n/ax/be, max 22dBm per chain 4x U.FL Connectors |
| Frequency Range | 5.15~5.825GHz |
| Modulation Techniques | OFDMA: BPSK, QPSK, 16-QAM, 64-QAM, 256-QAM, 1024QAM, 4096QAM |
| Channel Spectrum Widths for WLAN | Supports 20/40/80/160/240MHz at 5GHz |
| Operating Systems | Linux |
| Certification | REACH & RoHS Compliance |
| Environmental Temperature | Operating (Commercial Grade): -20°C to 70°C, Storage: -40°C to 90°C Operating (Industrial Grade): -40°C to 85°C, Storage: -40°C to 90°C |
| Environmental Humidity, Non-Condensing | Operating: 5% to 95%, Storage: Max. 90% |
| Dimensions (W x H x D) in mm | 62.7 X 57 X 15mm |

*Configurations are subject to change without notifications.

**Can be requested from respective sales executive.

RF Performance Table at 5GHz

| | Data Rate | TX Power (per chain) | TX Power (4 chains) | Tolerance |
|---------------------------|-----------|----------------------|---------------------|-----------|
| 5GHz 802.11be EHT20 | MCS0 | 22dBm | 28dBm | ±2dB |
| | MCS1 | 22dBm | 28dBm | ±2dB |
| | MCS2 | 22dBm | 28dBm | ±2dB |
| | MCS3 | 22dBm | 28dBm | ±2dB |
| | MCS4 | 22dBm | 28dBm | ±2dB |
| | MCS5 | 22dBm | 28dBm | ±2dB |
| | MCS6 | 21dBm | 27dBm | ±2dB |
| | MCS7 | 21dBm | 27dBm | ±2dB |
| | MCS8 | 20dBm | 26dBm | ±2dB |
| | MCS9 | 20dBm | 26dBm | ±2dB |
| | MCS10 | 19dBm | 25dBm | ±2dB |
| | MCS11 | 19dBm | 25dBm | ±2dB |
| | MCS12 | 18dBm | 24dBm | ±2dB |
| MCS13 | 18dBm | 24dBm | ±2dB | |
| 5GHz 802.11be EHT40 | MCS0 | 22dBm | 28dBm | ±2dB |
| | MCS1 | 22dBm | 28dBm | ±2dB |
| | MCS2 | 22dBm | 28dBm | ±2dB |
| | MCS3 | 22dBm | 28dBm | ±2dB |
| | MCS4 | 22dBm | 28dBm | ±2dB |
| | MCS5 | 22dBm | 28dBm | ±2dB |
| | MCS6 | 21dBm | 27dBm | ±2dB |
| | MCS7 | 21dBm | 27dBm | ±2dB |
| | MCS8 | 20dBm | 26dBm | ±2dB |
| | MCS9 | 20dBm | 26dBm | ±2dB |
| | MCS10 | 19dBm | 25dBm | ±2dB |
| | MCS11 | 19dBm | 25dBm | ±2dB |
| | MCS12 | 18dBm | 24dBm | ±2dB |
| MCS13 | 18dBm | 24dBm | ±2dB | |
| 5GHz 802.11be EHT80 | MCS 0 | 22dBm | 28dBm | ±2dB |
| | MCS 1 | 22dBm | 28dBm | ±2dB |
| | MCS 2 | 22dBm | 28dBm | ±2dB |
| | MCS 3 | 22dBm | 28dBm | ±2dB |
| | MCS 4 | 22dBm | 28dBm | ±2dB |
| | MCS 5 | 22dBm | 28dBm | ±2dB |
| | MCS 6 | 21dBm | 27dBm | ±2dB |
| | MCS 7 | 21dBm | 27dBm | ±2dB |
| | MCS 8 | 20dBm | 26dBm | ±2dB |
| | MCS 9 | 20dBm | 26dBm | ±2dB |
| | MCS 10 | 19dBm | 25dBm | ±2dB |
| | MCS 11 | 19dBm | 25dBm | ±2dB |
| | MCS 12 | 18dBm | 24dBm | ±2dB |
| MCS 13 | 18dBm | 24dBm | ±2dB | |

| | Data Rate | RX Specifications Sensitivity | Tolerance |
|---------------------------|-----------|-------------------------------|-----------|
| 5GHz 802.11be EHT20 | MCS0 | -96dBm | ±2dB |
| | MCS1 | -93dBm | ±2dB |
| | MCS2 | -91dBm | ±2dB |
| | MCS3 | -87dBm | ±2dB |
| | MCS4 | -84dBm | ±2dB |
| | MCS5 | -80dBm | ±2dB |
| | MCS6 | -78dBm | ±2dB |
| | MCS7 | -77dBm | ±2dB |
| | MCS8 | -73dBm | ±2dB |
| | MCS9 | -70dBm | ±2dB |
| | MCS10 | -67dBm | ±2dB |
| | MCS11 | -64dBm | ±2dB |
| | MCS12 | -61dBm | ±2dB |
| MCS13 | -58dBm | ±2dB | |
| 5GHz 802.11be EHT40 | MCS 0 | -93dBm | ±2dB |
| | MCS 1 | -91dBm | ±2dB |
| | MCS 2 | -88dBm | ±2dB |
| | MCS 3 | -84dBm | ±2dB |
| | MCS 4 | -82dBm | ±2dB |
| | MCS 5 | -78dBm | ±2dB |
| | MCS 6 | -76dBm | ±2dB |
| | MCS 7 | -75dBm | ±2dB |
| | MCS 8 | -71dBm | ±2dB |
| | MCS 9 | -68dBm | ±2dB |
| | MCS 10 | -64dBm | ±2dB |
| | MCS 11 | -61dBm | ±2dB |
| | MCS 12 | -59dBm | ±2dB |
| MCS 13 | -56dBm | ±2dB | |
| 5GHz 802.11be EHT80 | MCS 0 | -90dBm | ±2dB |
| | MCS 1 | -88dBm | ±2dB |
| | MCS 2 | -85dBm | ±2dB |
| | MCS 3 | -82dBm | ±2dB |
| | MCS 4 | -79dBm | ±2dB |
| | MCS 5 | -75dBm | ±2dB |
| | MCS 6 | -73dBm | ±2dB |
| | MCS 7 | -71dBm | ±2dB |
| | MCS 8 | -67dBm | ±2dB |
| | MCS 9 | -65dBm | ±2dB |
| | MCS 10 | -61dBm | ±2dB |
| | MCS 11 | -59dBm | ±2dB |
| | MCS 12 | -55dBm | ±2dB |
| MCS 13 | -52dBm | ±2dB | |

RF Performance Table at 5GHz

| | Data Rate | TX Power (per chain) | TX Power (4 chains) | Tolerance |
|----------------------------|-----------|----------------------|---------------------|-----------|
| 5GHz 802.11be EHT160 | MCS 0 | 22dBm | 28dBm | ±2dB |
| | MCS 1 | 22dBm | 28dBm | ±2dB |
| | MCS 2 | 22dBm | 28dBm | ±2dB |
| | MCS 3 | 22dBm | 28dBm | ±2dB |
| | MCS 4 | 22dBm | 28dBm | ±2dB |
| | MCS 5 | 22dBm | 28dBm | ±2dB |
| | MCS 6 | 21dBm | 27dBm | ±2dB |
| | MCS 7 | 21dBm | 27dBm | ±2dB |
| | MCS 8 | 20dBm | 26dBm | ±2dB |
| | MCS 9 | 19dBm | 25dBm | ±2dB |
| | MCS 10 | 19dBm | 25dBm | ±2dB |
| | MCS 11 | 18dBm | 24dBm | ±2dB |
| | MCS 12 | 18dBm | 24dBm | ±2dB |
| | MCS 13 | 18dBm | 24dBm | ±2dB |

| | Data Rate | RX Specifications Sensitivity | Tolerance |
|----------------------------|-----------|-------------------------------|-----------|
| 5GHz 802.11be EHT160 | MCS 0 | -88dBm | ±2dB |
| | MCS 1 | -84dBm | ±2dB |
| | MCS 2 | -82dBm | ±2dB |
| | MCS 3 | -79dBm | ±2dB |
| | MCS 4 | -76dBm | ±2dB |
| | MCS 5 | -72dBm | ±2dB |
| | MCS 6 | -70dBm | ±2dB |
| | MCS 7 | -68dBm | ±2dB |
| | MCS 8 | -64dBm | ±2dB |
| | MCS 9 | -62dBm | ±2dB |
| | MCS 10 | -58dBm | ±2dB |
| | MCS 11 | -55dBm | ±2dB |
| | MCS 12 | -53dBm | ±2dB |
| | MCS 13 | -50dBm | ±2dB |

Component Map

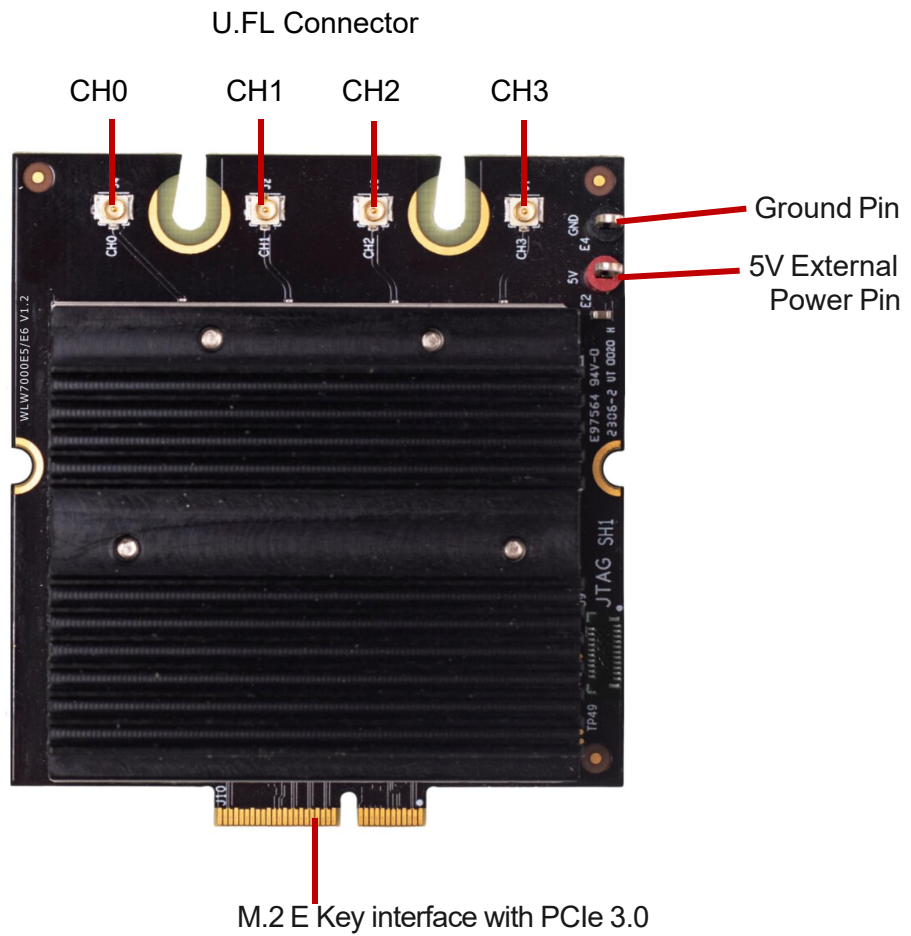

Mechanical Dimensions

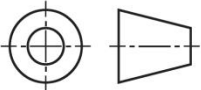
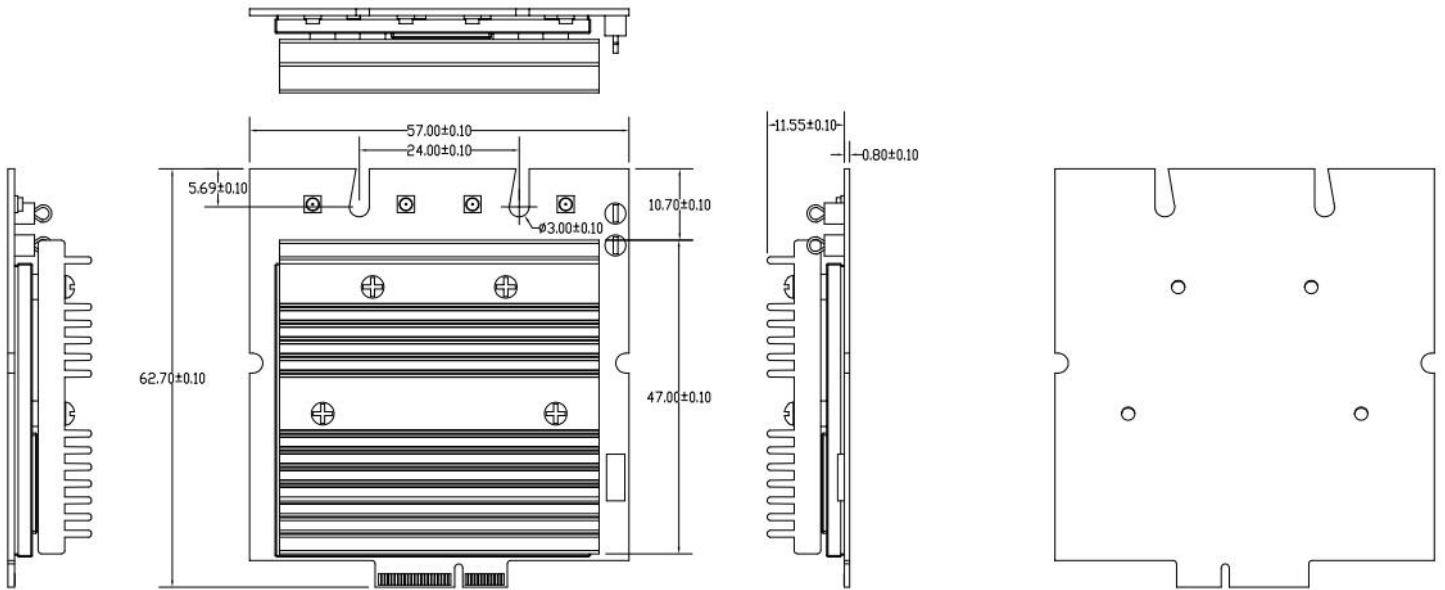

All dimensions are in mm.

Ordering Configuration

| Item Code | Model | Description |
|--|-------------|---|
| WLW7000E5 8A0624S-TE WLW7000E5 8A0674S-TE | WLW7000E5 | QCN6224/6274 4x4 802.11a/n/ac/ax/be support 5GHz M.2 E Key interface with PCIe 3.0 |
| WLW7000E5 8A0974S-TE | WLW7000E5-I | QCN9274 4x4 802.11a/n/ac/ax/be support 5GHz M.2 E Key interface with PCIe 3.0 |

Chipsets Comparisons

| | | QCN6224 | QCN6274 | QCN9274 |
|------------------------|------------------------|----------------------|----------------------|----------------------|
| Band Operation | 4 Single Band | ✓ | ✓ | ✓ |
| | 2+2 Dual Band | ✓ | ✓ | ✓ |
| | 2.4GHz | ✓ | ✓ | ✓ |
| | 4.9GHz | - | - | ✓ |
| | 5GHz | ✓ | ✓ | ✓ |
| | 6GHz | - | ✓ | ✓ |
| | Channel Support | Up to 160MHz at 5GHz | Up to 320MHz at 6GHz | Up to 320MHz at 6GHz |
| Performance | 4K QAM | ✓ | ✓ | ✓ |
| | #clients | 128 | 256 | 512 |
| | #OFDMA users | 8 | 16 | 37 |
| | DL OFDMA + TxBF | - | ✓ | ✓ |
| | DL/UL MU-MIMO | ✓ | ✓ | ✓ |
| Advanced 11be Features | WFA certified MLO | ✓ | ✓ | ✓ |
| | Puncture | Static | Static | Static & Dynamic |
| Others | DPD | ✓ | ✓ | ✓ |
| | FIPS | - | - | ✓ |
| Software Packages | Provisioned Multi Link | ✓ | ✓ | ✓ |
| | Dense Deployment | ✓ | ✓ | ✓ |
| | Location & RF Sensing | ✓ | ✓ | ✓ |